



# D5200S REC HSG

## 1-179958-6

Breaking strength improvement

Rev C.2016/6/29



EVERY CONNECTION COUNTS



# Improvement idea

## Current product

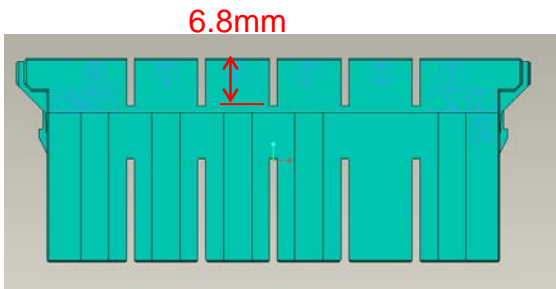
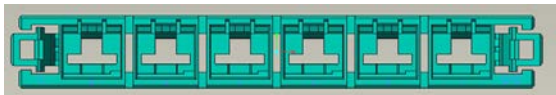

## Improvement idea

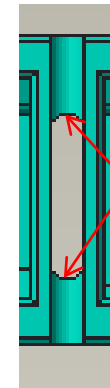
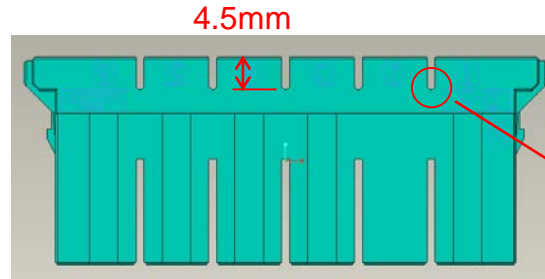
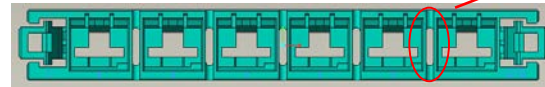

Add  
FULL R  
10PLC

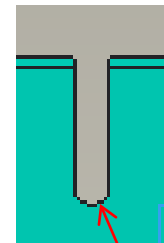

Add  
FULL R  
10PLC

# Summary of test result by prototype samples

## 1. Breaking strength on case1

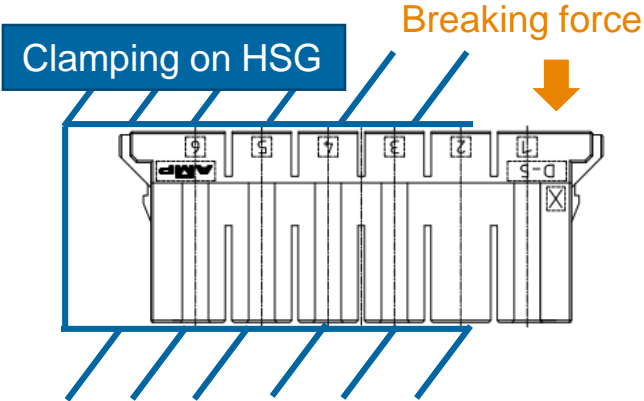

	Breaking force (N)	
	Current	Prototype
MAX	260.0	389.0
MIN	254.0	354.0
AVE	257.0	372.5

Picture after the test

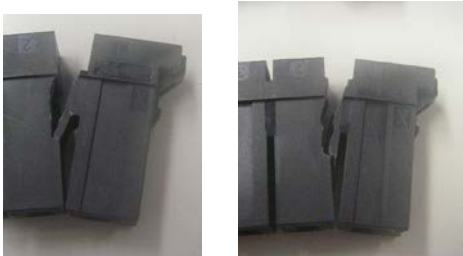

Current product

Prototype

## 2. Breaking strength on case2

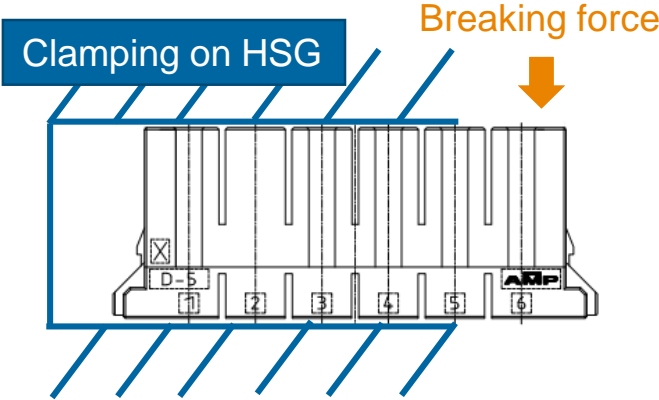

	Breaking force (N)	
	Current	Prototype
MAX	318.0	533.0
MIN	271.5	402.0
AVE	300.0	452.5

Picture after the test



Current product

Prototype

Breaking force increase approximately 150%.



### 3. Breaking strength on case3

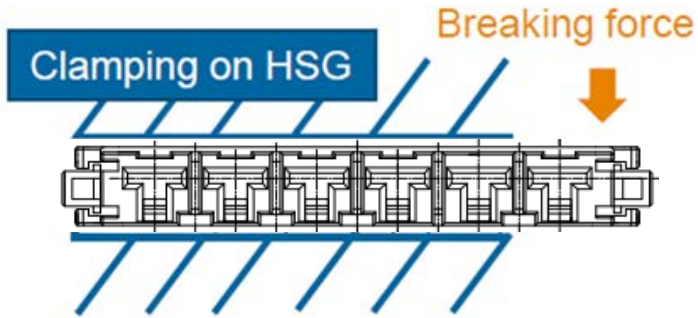

	Breaking force (N)	
	Current	Prototype
MAX	182.5	281.5
MIN	157.5	252.5
AVE	172.2	264.7

Picture after the test

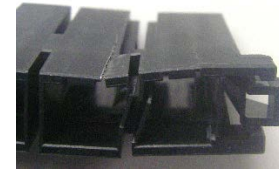

Breaking force increase approximately 150%.



Current product

Prototype